

INSTRUCTIONS

Swooper Banners

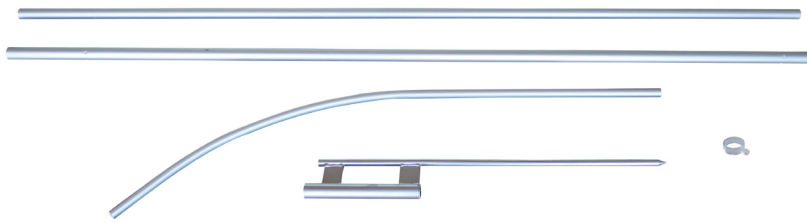

Includes:
Straight Poles (2)
Bent Pole
Ground Spike
EZ Mount Ring

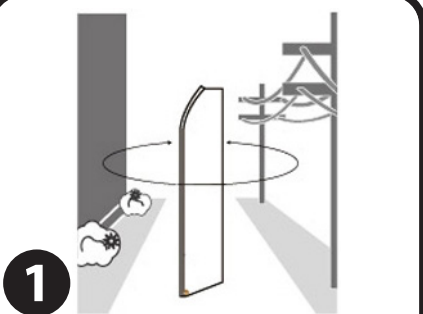

1

DO NOT install near trees, wires, poles or buildings.

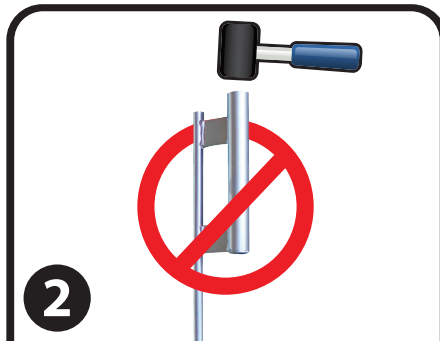

2

Install ground spike by hammering on the top of the main part of the steel rod with a rubber mallet (not included). **DO NOT hammer peg attachment.**

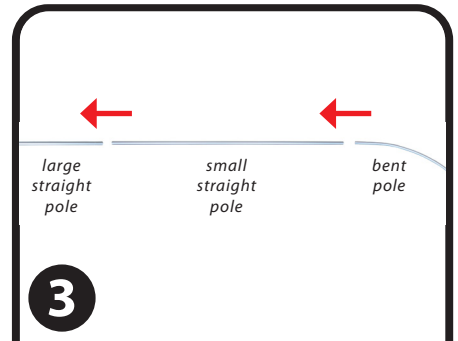

3

Arrange all poles from largest straight pole to smallest straight pole to bent pole and connect.

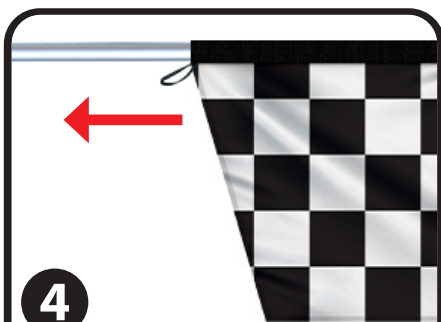

4

Starting at bent pole, slide banner onto assembled pole. Make sure to slide the pole completely inside the reinforced pocket at the end of the pole sleeve.

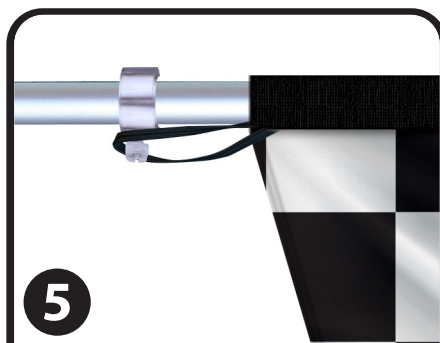

5

Slide EZ mount ring onto pole to bottom of the banner. Hook loop over screw on ring. Pull ring downward until banner reaches desired tautness. Tighten screw on ring. Place assembled pole with banner into ground spike.

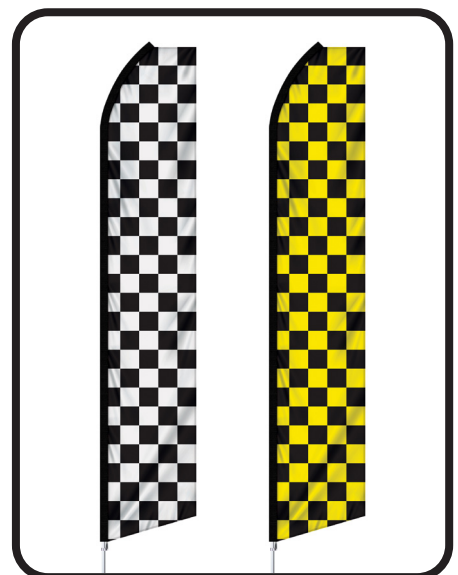

This product is for outdoor promotional use only and should not be left out in extreme weather conditions. Please use common sense guidelines and do not display this product outdoors when extreme winds or storms may be present.